



225hp V6

Exhilarating innovation.

The DNA of the flagship XTO is evident in the new 225hp V6, and the legacy continues with a combination of innovative new features, enhanced reliability, and exhilarating performance.

Stronger reverse and low-speed manoeuvring – the Thrust Enhancing Reverse Exhaust (TERE) design provides for maximum command and control, at low speeds. It is particularly effective in close quarter handling situations, and has outstanding reverse thrust combined with excellent control characteristics.

Yamaha's exclusive TotalTilt function allows complete tilt-up from any position with a double-push of the trim/tilt button. No more holding the trim button, makes for greater convenience when complete up or down tilt is desired, and the integrated tilt limiter helps to prevent inadvertent damage.



- Fully compatible with optional bolt-on electric steering for improved serviceability.
- TotalTilt™ cu limită integrată a înclinării, pentru remorcare fără efort și comoditate în timpul înclinării.
- Thrust Enhancing Reverse Exhaust (TERE) for outstanding reverse thrust and control when manoeuvring.
- Elegant, sleek, lightweight design.
- Superior engine mounts for less vibration and a softer ride.
- New and improved lower unit: new components, design features and improved durability.

Exhilarating innovation.

The new 225hp V6 shares the DNA of the flagship XTO, reflected in cutting-edge technology and Yamaha engineering excellence resulting in outstanding power and thrilling performance. By fusing power, efficiency and light weight, Yamaha's innovative design sets the standard for V6 outboard performance.

The new Yamaha 225hp V6 represent Yamaha's commitment to deliver products that provide a more user-friendly interface for customers, seen in the new TotalTilt function, and boat builders, whilst continuing to deliver on incredible power and enhanced reliability.

Designed for use by professionals, enthusiasts and new users, engineered to empower people's passions, the big block 225hp V6 provides versatility and additional confidence on the water through the Thrust Enhancing Reverse Exhaust (TERE) system, as well as delivering exciting performance.

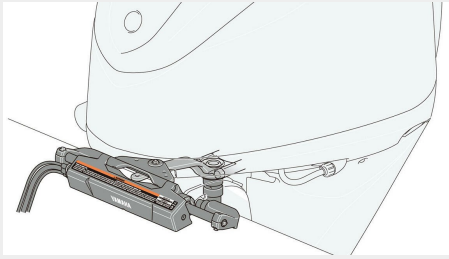

Fully compatible with optional bolt-on electric steering

The 225hp V6 is fully compatible with optional digital electric steering (DES). Yamaha DES offers a clean spacious bilge. There are no pumps, hoses, control units, need for fluid filling, or clean-up and no special bleeder ports. For re-powers, your technicians can rig DES significantly faster and more easily.

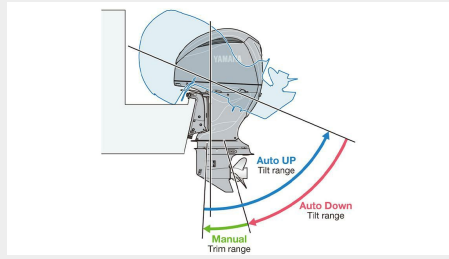

TotalTilt™ function with integrated tilt limit

Yamaha's exclusive TotalTilt™ function allows complete tilt up or down (until trim ram contacts) from any position with a simple double-push of the respective tilt button. During the process, a buzzer sounds to alert crew to keep clear of the outboard, and the integrated tilt limiter helps to prevent inadvertent damage.

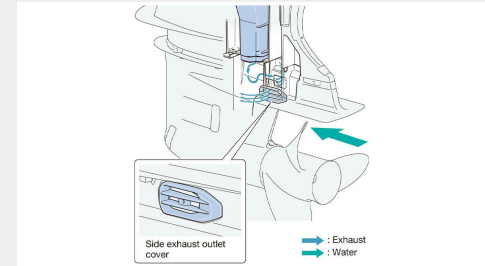

Thrust Enhancing Reverse Exhaust (TERE)

Stronger reverse and low-speed manoeuvring – TERE keeps exhaust bubbles above the anti-ventilation plate and out of the propeller below 2500 rpm, when in reverse. The prop bites only bubble free water, resulting in outstanding reverse thrust and control. Combine with optional Digital Electric Steering and Helm Master EX joystick for further enhanced manoeuvrability – very helpful around docks and confined spaces.



Elegant, sleek, lightweight design

Capitalising on many styling cues from its big brother, the XTO-like appearance now features a colour-matched lower unit, a new one-piece top cowling with water-draining air duct moulding, a new bottom cowling, apron shape, and premium graphics. Stunning new looks meet proven performance to compliment and complete a broader array of premium boats.



Superior engine mounts

Taken from the XTO, the lower motor mounts are larger and softer resulting in less vibration and a softer ride.



New and improved lower unit

The new 4.2-liter 225hp V6 has a new and improved lower unit, featuring new components and design features. The new design of the gear tooth profile has improved contact and reduces surface pressure. In addition, the durability has been improved by changing the oil flow inside the lower case and the bearings that support the gears.

Motor

Tip motor	4 timpi, DOHC
Capacitate cilindrică	4169 cm ³
Nr. de cilindri/Configurație	60-deg. V6
Alezaj X Cursă	96.0 x 96.0 mm
Randament al axului elicei la limită medie	165.5 kW (225 ps)
Limită de operare completă al acceleratorului	5000-6000 r/min
Sistem de ungere	Carter umed
Sistem de alimentare cu combustibil	IEB
Sistem de aprindere/avans	TCI
Sistem de aprindere	Electric
Raport de demultiplicare	1.75 (21/12)
Carburatoare	Injecție de carburant

Dimensiuni

Capacitatea rezervorului de ulei	6.3 L/ 6.0 L *with/without oil filter exchange
Greutate fără elice	260 kg - 268 kg

Caracteristici suplimentare

Control	Drive By Wire (DBW - F200G)
Metoda asietă & înclinare	Asietă & înclinare
Tambur de inducție / Alternator	70 A (max) (battery charging: 55 A)
Imobilizator motor	YCOP optional
Elice	Opționale
Model cu elice care se rotește în sensul acelor de ceas	Disponibil
Shallow Water Drive	Standard
Sistem de încărcare cu două baterii	Opționale
Digital Network Gauge (6Y8/6YC)	Opționale
Tilt limiter	Standard
Digital Network Gauge II (CL7)	Opționale
Shift Dampener System (SDS)	Opționale
Full tilt up angle	70
YCOP (Imobilizer)	Aplicabil



225hp V6

Please note this 2021 production year outboard engine will be available in Europe from Season 2022 onward. For more information please contact your local Dealer.

Toate informațiile din prezentul catalog sunt oferite numai cu titlu orientativ și pot fi supuse modificării fără înștiințare prealabilă. Fotografiiile pot prezenta ambarcațiuni conduse de profesioniști, iar publicarea acestora nu are ca scop sau nu implică oferirea de recomandări sau indicații cu privire la utilizarea în siguranță sau stilul de utilizare. Respectă întotdeauna normele locale de navigație. Poartă întotdeauna dispozitivul personal de plutire și echipamentele de siguranță recomandate atunci când navighezi.